



Gyproc Plasters
Built to reflect **YOU**



A home is never a place. It's a feeling.

A home is where love resides, memories are created, friends are welcome and family is forever. And only a home that looks and feels beautiful gives you the feeling of being home. So what makes a beautiful home? The furnishings, upholstery, the quirks from our personalities that we smear on our walls. But a wall without the most perfect finish can never reflect the character of your beautiful home. Which is why plastering is important. So that every wall of your dream home can create the seamless, smooth feeling of being at home.



1665



TRUST

Saint-Gobain founded in 1665 in France
(350+ year's of trust serving customers
worldwide)

EXPERTISE

Gypsum business founded in UK in 1917
(100+ Years of expertise in gypsum)



1917



SERVICE

Gyproc India founded in 1985 having 3 plaster plants
at Wada (near Mumbai), Chennai and Bikaner.
(35+ years of Making in India and servicing
Indian Customers)

1985





Saint-Gobain ranked among the Top 100 Global Innovators
for the last 9 years consecutively

- Saint-Gobain Global Research Centre in Chennai develops products for hot & humid climates like India
- 1 of 4 Products sold today did not exist 5 years back
- More than 400 Patents developed each year by the group
- All our products are “Green Certified”
by CII - Indian Green Building Council, LEED V4 & GRIHA



Comparison between **Sand-Cement** and **Gypsum Plaster**

Shrinkage Cracks

Sand-Cement Plaster:

High heat of hydration generating shrinkage cracks

Gypsum Plaster:

It has self setting properties and produces less heat of hydration, hence does not develop shrinkage cracks

Water-Saving

Sand-Cement Plaster:

Requires 21 Days of Water curing
17.6 lit/Sqft

Gypsum Plaster:

No Water Curing
1 lit/Sqft

17 Times Lower Water Consumption



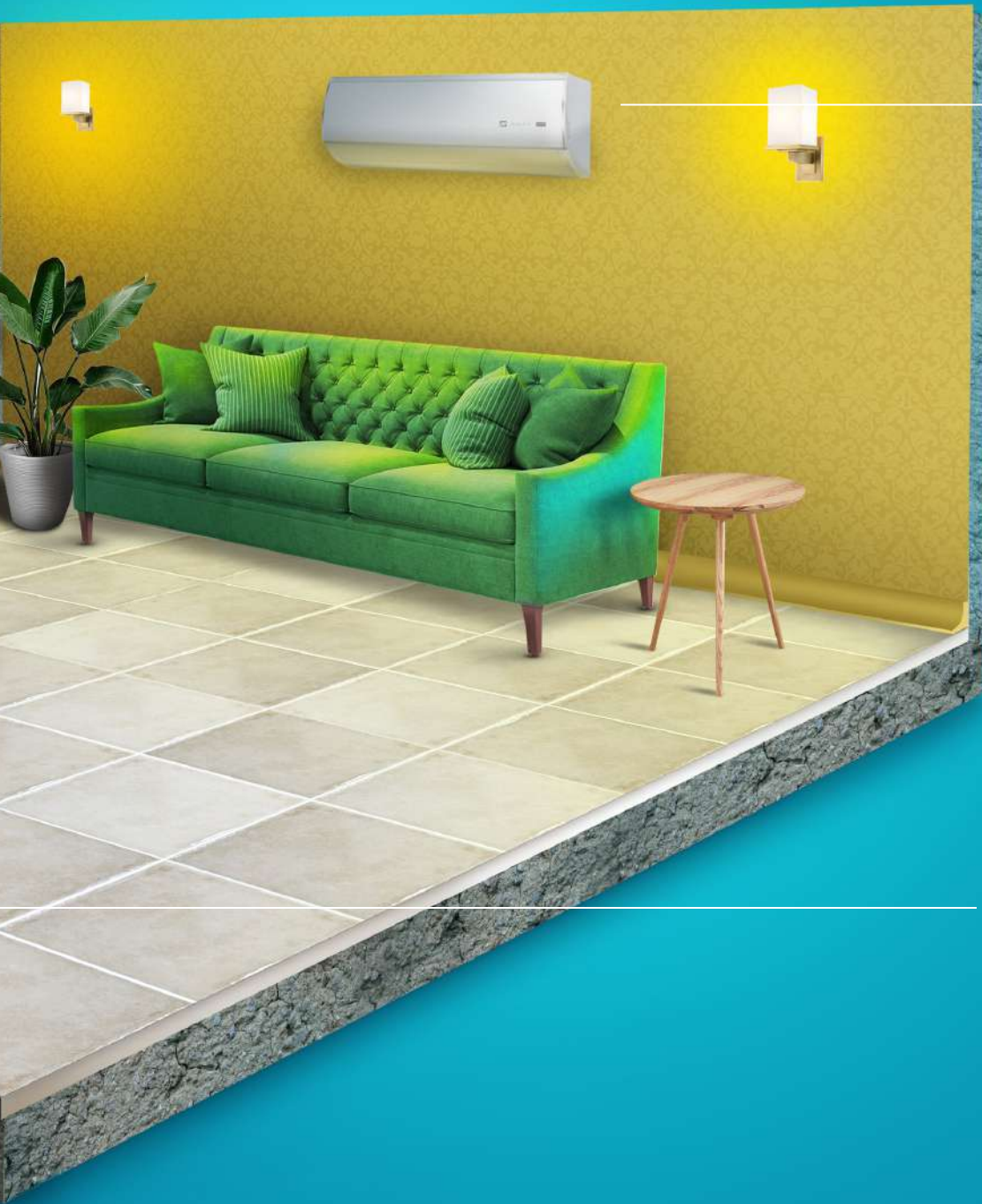

Electricity Consumption



Sand-Cement Plaster:

Higher Thermal
Conductivity
0.72 W/m - K

Gypsum Plaster:

Lower Thermal
Conductivity
0.25 W/m - K

10% Saving in Electricity

Time-Saving



Sand-Cement Plaster:

Requires 28 days to
start painting process

Gypsum Plaster:

Ready for painting
in 7 days

Net Saving of 21 Days

HAVE YOUR WALLS STARTED LOSING THEIR CHARM?

Sand-cement plaster often leads to the following problems



Capillary Action

Since the construction materials are porous, water penetrates through small capillaries into the walls, leading to dampness which can eventually spread across the entire surface.



Efflorescence

When moisture migrates through the walls, it also leads to deposition of salts and minerals on the surface. This is known as efflorescence.



Penetrating Dampness

Penetrating dampness is due to rain water successfully penetrating from the outside of a wall and into your home

It is observed that the root cause of most of these major problems is **MOISTURE.**





GYPROC ELITE MR

is the perfect solution!

Elite MR (Moisture Resistance) is a one-coat gypsum plaster specifically designed to provide extra protection with low absorption of moisture in the air or from surfaces giving excellent results in skirting areas, with problems arising out of capillary action, efflorescence and penetration dampness.

Tiling over Elite MR

Tiles up to 20 Kgs/M2 can be applied directly over Elite MR with the help of suitable Tile Adhesive. Polished or smoothed Elite MR surface should be roughened before tiling.

FEATURES



Coverage upto
100 m2/MT



Total Water
Absorption < 10%



High Setting
Time



Low Thermal
Conductivity

BENEFITS



Protection from
Mold and Fungal
Growth



Higher Moisture
Resistance



Protects Top
Coats



Energy
Saving

AREA OF APPLICATION



Bricks



Blocks



Concrete

Gyproc Glass Fiber Mesh

*Available in two sizes 0.15M x 50M and 1M X 50M

Glass Fiber Mesh is a solution which guarantees excellent protection from formation of cracks at different joints and conduits. This is used in beams and column joints, plumbing and electrical work chasing areas and doors and window joints among others.



FEATURES



Superior Weaving



0.15M X 50M
1M X 50M



Mesh Size
5MM X 5Mm



145 GSM

BENEFITS



Convenient and Easy to Use



Can be used on both Gypsum and Sand Cement



Tensile Strength
>1500 N/5 cm²



Crack Free Surface

Gyproc BOND it

*Available in 1kg, 5kg, 10kg and 20kg plastic buckets

*Coverage in single coat application under Lab Conditions

BOND it is a bonding agent for gypsum plaster that enables preparation of ceiling and wall surfaces (especially RCC surfaces) within 24 hours. It completely eliminates the risk of de-bonding of gypsum plaster from low suction backgrounds viz. RCC surfaces (Aluminium formwork and ceilings). BOND it with its unique formulation of polymers, additives and sand fillers offers dual benefits of mechanical and chemical bonding.



FEATURES



Dual Bonding
Chemical and
Mechanical Key



Single Coat
Brush Application



No Tackiness
Required



Green Colour

BENEFITS



2X More
Strength



10X Faster
Application



Easy
Supervision

AREAS OF APPLICATION

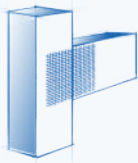

Beam and Column Joints



Plumbing and Electrical Work Chasing Areas

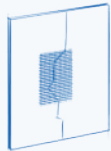

Areas with Thin Plaster

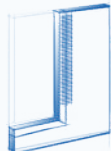

Door and Window Joints

Glass Fiber Mesh

AREAS OF APPLICATION



RCC Columns

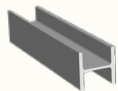

Beams



Concrete Surfaces



Slabs



Sheer Walls

Technical Parameters

Range/Value

Drying Time	1 Day
Open Time for Plastering	2 to 10 Days
Coverage	5 m ² /kg*
Ambient Temperature Requirement	5 to 45 °C
Pull Out Strength (Failure Load)	>1.01 MPa

BOND it





Gyproc Elite 100

One Coat Gypsum Plaster

Elite 100 one coat gypsum plaster is a replacement of traditional sand cement plaster and is suitable for application on most internal surfaces including brick, block and concrete (RCC surfaces). It consists of light weight aggregates like "Perlite" and special additives to enhance coverage, setting time and workability.



Gyproc Supreme 80

One Coat Gypsum Plaster

Supreme 80 one coat gypsum plaster is a replacement of traditional sand cement plaster and is suitable for application on most internal surfaces including brick, block and concrete (RCC surfaces). It consists of light weight aggregates like "Vermiculite" and special additives to enhance coverage, setting time and workability.



Gyproc Xpert +

Stucco Gypsum Plaster

Xpert+ is a stucco gypsum plaster suitable for application like POP punning (over sand and cement plaster), bull marks, level strips and any other application which uses traditional POP. Its enhanced setting time of 10-15 minutes helps in controlling the on-site wastages typically associated with traditional POP.

Profiles & Accessories

PVC Corner Beads

Corner Beads provides extra protection to corners of the walls and reduces the cost of maintenance.



PVC Tile Skirting

Tile Skirting creates uniformity, enhances aesthetics, avoids cracks and reduces cost of maintenance.



PVC inner corner bead

Inner Corner Bead increases durability, enhances aesthetics and reduces of maintenance.

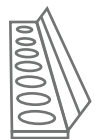

CERTIFICATION AND GREEN CREDENTIALS

Gyproc plasters are made to not just meet but exceed the requirements of the various IS and global standards. We provide certifications on quality from the leading labs in the country.

Sustainability is at the heart of everything we do at Saint-Gobain. All the Gyproc plaster products are certified by the leading green building agencies for GRIHA and GreenPro certification thus enabling to earn you the maximum points for your Green Building.



GRIHA Certificates



GreenPro Certificates



IS 2547 Certificates

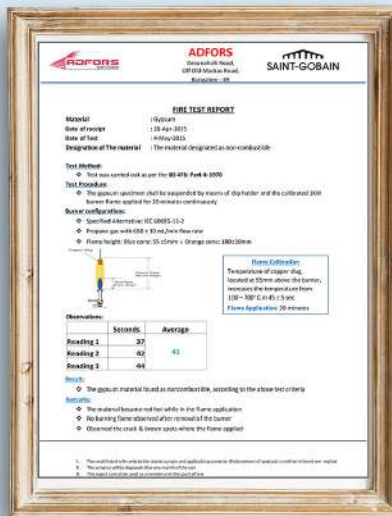

Fire Certificate



Moisture Resistance Test



VOC Certificate



Contact us:

E-mail: gyprocindia@saint-gobain.com

Website: www.gyproc.in | Toll Free: 1800 103 7897

